

LT Tubular Solenoid

Model LT12x19



1425 Lake Avenue, Woodstock, IL 60098

Features:

- Long life construction
- Plunger stop for quiet operation
- DC solenoid applications only
- RoHS Compliant
- UL Recognized
- Stainless steel guide tube
- Teflon coated plunger
- Coil Termination: 6.5" Wire leads
- 22 AWG (standard)



Electrical:

- Coil Voltages: 6, 12, 24, 48, 110VDC standard
- Duty Cycle: 100% Continuous, 25% Intermittent, 10% Intermittent, 1% Pulse
- Coil treatment: Tape Wrapped
- Insulation Class: Class A Rating - 105°C (221°F)
- Dielectric Strength: 1500V 60 Hz

Mechanical:

- Size: 2.37" (L) x 1.5" (D)
- Plunger Diameter: 0.5"
- Plunger Guide Material: Stainless Steel
- Mounting: Hex Nut
- Weight: Plunger 2.2 oz, Total 14.6 oz
- Life Expectancy: 10 Million Cycles¹

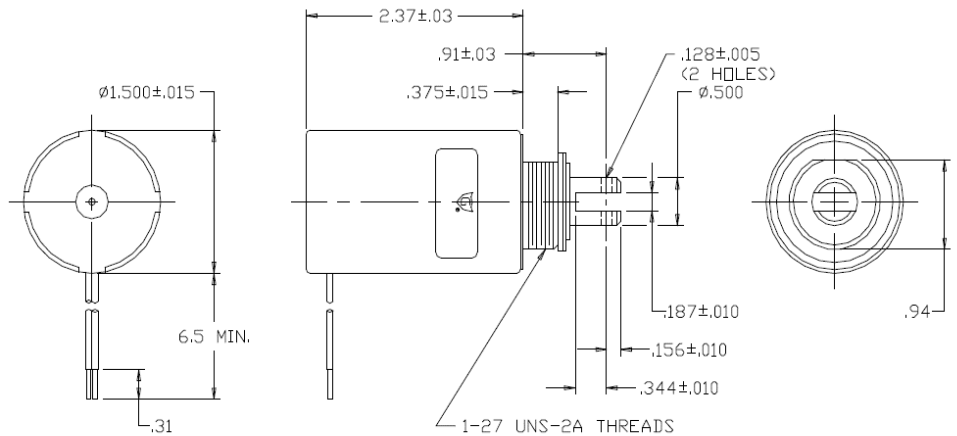

Standard Part Numbers

Model No.	Part No.	Duty Cycle	Voltage	Resistance ² (Ω)	Power (W)	Current
LT12x19-C-12D	A420-064866-00	Cont.	12VDC	14.8	10.2	811 mA
LT12x19-I-12D	A420-064867-00	Inter.	12VDC	4.6	32.4	2.58 A
LT12x19-C-24D	A420-064868-00	Cont.	24VDC	71.8	8.4	334 mA
LT12x19-I-24D	A420-064869-00	Inter.	24VDC	18.6	32.5	1.29 A

² - Coil resistance tolerance +/- 5%

Contact us for custom voltages or duty cycles

Solenoid shown energized with plunger fully seated
Supplied with mounting bracket, hex nut and lock washer shipped loose

Available Customization:

- Plunger
 - Lead and Connector
 - DC Voltage / Duty Cycle
 - Termination
 - Insulation systems up to class H 180° C (356° F)
- * Minimum quantities apply

Stroke (in.)	Typical Pull Force Ounces [N] @ 20°C (68°F) (Distance from fully seated position)									HOLDING FORCE Ounces [N]	Power (W)
	0.050	0.125	0.250	0.375	0.500	0.625	0.750	1.000			
Continuous 100%	110 [30.6]	70 [19.5]	32 [8.9]	20 [5.6]	15 [4.2]	8 [2.2]	5 [1.4]	3 [0.8]	139 [38.6]	8.6	
Intermittent 25%	170 [47.3]	140 [38.9]	97 [27]	75 [20.9]	45 [12.5]	35 [9.7]	20 [5.6]	10 [2.8]	160 [44.5]	32.4	
Intermittent 10% ³	233 [64.8]	212 [58.9]	166 [46.2]	137 [38.1]	110 [30.6]	87 [24.2]	78 [21.7]	45 [12.5]	455 [126.5]	83	
Pulse 1% ³	285 [79.2]	263 [73.1]	225 [62.6]	196 [54.5]	163 [45.3]	145 [40.3]	116 [32.2]	75 [20.9]	N/A	130	

Optional Return Spring Kit
A490-367460-18

Continuous Duty 100% = 100% On Time
Intermittent Duty 25% = 25% On Time (100 Seconds On Max Followed By 300 Seconds Off)
Intermittent Duty 10% = 90% On Time (10 Seconds On Max Followed By 90 Seconds Off)
Pulse Duty 1% = 99% On Time (1 Second On Max Followed By 99 Seconds Off)
³ - Calculated force values to be verified in application



www.kelcoind.com

Information contained in this specification sheet subject to change without notice. Guardian Electric ©

