

Model LT12x13



📍 1425 Lake Avenue, Woodstock, IL 60098



Features:

- Long life construction
- Plunger stop for quiet operation
- DC solenoid applications only
- RoHS Compliant
- UL Recognized
- Stainless steel guide tube
- Teflon coated plunger
- Coil Termination: 6.5" Wire leads
- 22 AWG (standard)

Electrical:

Coil Voltages: 6, 12, 24, 48, 110 VDC standard
Duty Cycle: 100% Continuous, 25% Intermittent,
10% Intermittent, 1% Pulse
Coil treatment: Tape Wrapped
Insulation Class: Class A Rating - 105°C (221°F)
Dielectric Strength: 1500V 60 Hz

Mechanical:

Size: 1.63" (L) x 1.5" (D)
Plunger Diameter: 0.5"
Plunger Guide Material: Stainless Steel
Mounting: Hex Nut
Weight: Plunger 1.8 oz, Total 10.6 oz
Life Expectancy: 10 Million Cycles¹

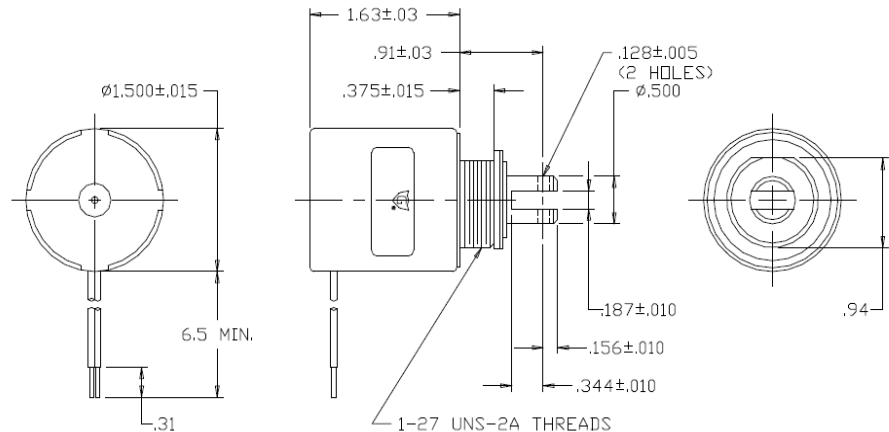

Standard Part Numbers

| Model No. | Part No. | Duty Cycle | Voltage | Resistance ² (Ω) | Power (W) | Current |
|---------------|----------------|------------|---------|--------------------------------|--------------|---------|
| LT12x13-C-12D | A420-064858-00 | Cont. | 12VDC | 18.3 | 8.3 | 656 mA |
| LT12x13-I-12D | A420-064859-00 | Inter. | 12VDC | 5.9 | 25.6 | 2.03 A |
| LT12x13-C-24D | A420-064860-00 | Cont. | 24VDC | 71.2 | 8.5 | 337 mA |
| LT12x13-I-24D | A420-064861-00 | Inter. | 24VDC | 22 | 27.5 | 1.09 A |

2 - Coil resistance tolerance $\pm 5\%$

Contact us for custom voltages or duty cycles

Solenoid shown energized with plunger fully seated
Supplied with mounting bracket, hex nut and lock washer shipped loose

Available Customization:

- Plunger
 - Lead and Connector
 - DC Voltage / Duty Cycle
 - Termination
 - Insulation systems up to class H 180° C (356° F)
- * Minimum quantities apply**

* Minimum quantities apply

| Typical Pull Force Ounces [N] @ 20°C (68°F) (Distance from fully seated position) | | | | | | | | HOLDING FORCE Ounces [N] | Power (W) |
|--|------------|------------|------------|------------|-----------|-----------|-----------|--------------------------------|--------------|
| Stroke (in.) | 0.050 | 0.125 | 0.250 | 0.375 | 0.500 | 0.625 | 0.750 | | |
| Continuous 100% | 90 [25] | 45 [12.5] | 20 [5.6] | 15 [4.2] | 5 [1.4] | 3 [0.8] | 1.5 [0.4] | 100 [27.8] | 8.3 |
| Intermittent 25% | 160 [44.5] | 118 [32.8] | 67 [18.6] | 40 [11.1] | 20 [5.6] | 10 [2.8] | 7 [1.9] | 144 [40] | 26 |
| Intermittent 10% ³ | 221 [61.4] | 185 [51.4] | 143 [39.8] | 107 [29.7] | 94 [26.1] | 45 [12.5] | 25 [7] | 387 [107.6] | 78.5 |
| Pulse 1% ³ | 275 [76.5] | 250 [69.5] | 210 [58.4] | 165 [45.9] | 115 [32.] | 75 [20.9] | 48 [13.3] | N/A | 156.1 |

Continuous Duty 100% = 100% On Time

Intermittent Duty 25% = 25% On Time (100 Seconds On Max Followed By 300 Seconds Off)

Intermittent Duty 10% = 90% On Time (10 Seconds On Max Followed By 90 Seconds Off)

Pulse Duty 1% = 99% On Time (1 Second On Max Followed By 99 Seconds Off)

³ - Calculated force values to be verified in application



www.Kelcoind.com

Information contained in this specification sheet subject to change without notice. Guardian Electric ©



Optional Return Spring Kit

A490-367460-19