



SUBMITTAL

NOVEMBER 2023

PROJECT	
CUSTOMER	
ENGINEER	
ARCHITECT	

*UL LISTED #150 300 SERIES SS SCH40
PIPE MALE THREAD END CONNECTOR
(18" OAL)*

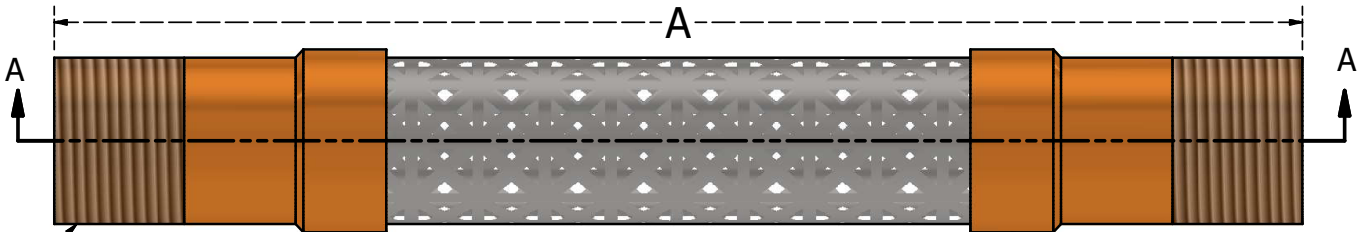

300 SERIES STN STL SCH40
MALE PIPE THREAD ENDS TYP

T-304 SS BRAID COLLAR

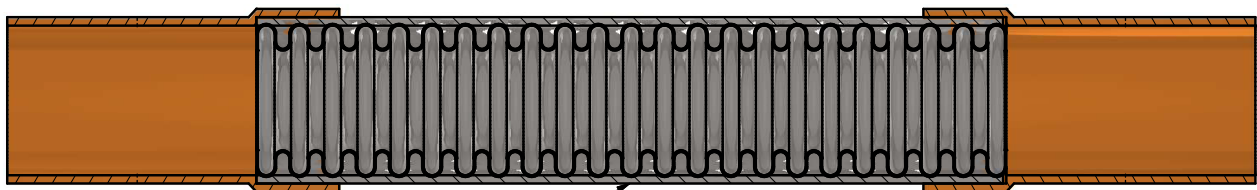

T-321 SS HOSE
T-304 SS BRAID

QTY.	PART #	HOSE DIAMETER (IN)	PRESSURE RATING @ 70 F (PSI)	PRESSURE RATING @ 250 F (PSI)	'A' = OAL	WEIGHT (LBS)	LATERAL MOVMENT
	F004KFCMPS18UL	1/2"	175	154	18"	0.50	1.370"
	F006KFCMPS18UL	3/4"	175	154	18"	0.88	1.650"
	F010KFCMPS18UL	1"	175	154	18"	1.12	1.880"
	F012KFCMPS18UL	1 1/4"	175	154	18"	1.75	2.100"
	F014KFCMPS18UL	1 1/2"	175	154	18"	2.26	1.830"
	F020KFCMPS18UL	2"	175	154	18"	3.10	1.720"
	F024KFCMPS18UL	2 1/2"	175	154	18"	4.65	0.835"
	F030KFCMPS18UL	3"	175	154	18"	5.55	0.750"
	F040KFCMPS18UL	4"	175	154	18"	10.35	0.615"

PRESSURE REDUCTION FACTOR FOR T-304 SS BRAID ABOVE 70 F

TEMP (*F)	FACTOR
70	1.00
200	0.91
300	0.85
400	0.78
500	0.77
600	0.76

NOTE:
FOR SAFE WORKING
PRESSURE MULTIPLY PRESSURE
RATING AT 70°F BY THE APPLICABLE
CORRECTION FACTOR



**1425 LAKE AVE
WOODSTOCK, IL, 60098
815-334-3600
www.kelcoind.com**