

# DC Tubular Solenoid

## Model T12x19



1425 Lake Avenue, Woodstock, IL 60098

### Features:

- High performance construction
- Available return spring kit
- DC solenoid applications only
- See TP12x19 for push application
- RoHS Compliant
- UL recognized
- Coil Termination: 6.5" Wire leads
- 22 AWG (standard)

### Electrical:

- Coil Voltages: 6, 12, 24, 48, 110 VDC standard
- Duty Cycle: 100% Continuous, 25% Intermittent, 10% Intermittent, 1% Pulse
- Coil treatment: Tape Wrapped
- Insulation Class: Class A Rating - 105°C (221°F)
- Dielectric Strength: 1500V 60 Hz

### Mechanical:

- Size: 2.38" (L) x 1.5" (D)
- Plunger Diameter: 0.5"
- Plunger Guide Material: Plastic
- Mounting: Hex Nut
- Weight: Plunger 2.2 oz, Total 14.2 oz
- Life Expectancy: 1 Million Cycles<sup>1</sup>

<sup>1</sup> - Dependent on load conditions

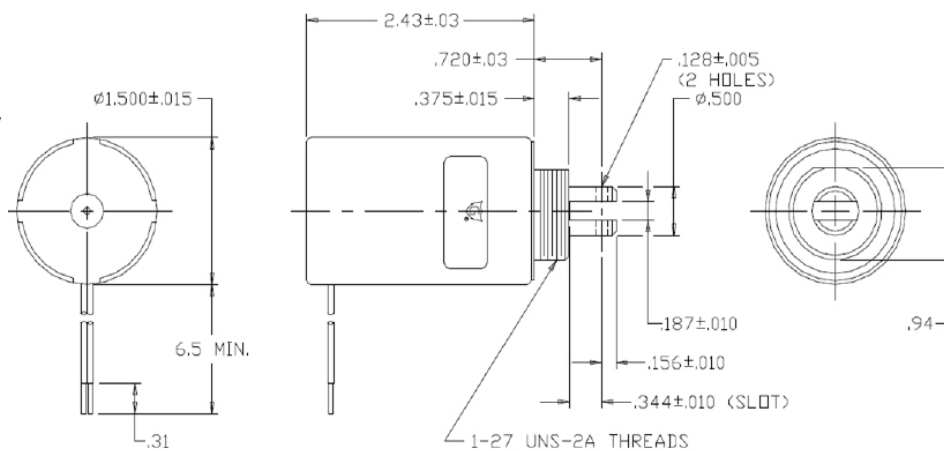

### Standard Part Numbers

Model	Part Number	Duty Cycle	Voltage	Resistance <sup>2</sup> (Ω)	Power (W)	Current
T12x19-C-12D	A420-066842-00	Cont.	12VDC	17.5	8.6	686 mA
T12x19-I-12D	A420-066843-00	Inter.	12VDC	5.6	27	2.14 A
T12x19-C-24D	A420-066844-00	Cont.	24VDC	68	8.9	353 mA
T12x19-I-24D	A420-066845-00	Inter.	24VDC	22.1	27.4	1.09A

<sup>2</sup> - Coil resistance tolerance +/- 5%

Contact us for custom voltages or duty cycles

Solenoid shown energized with plunger fully seated  
Supplied with mounting bracket, hex nut and lock washer shipped loose

### Available Customization:

- Plunger
- Lead and Connector
- DC Voltage / Duty Cycle
- Termination
- Insulation systems up to class H 180° C (356° F)

\* Minimum quantities apply

Typical Pull Force Ounces [N] @ 20°C (68°F) (Distance from fully seated position)									HOLDING FORCE Ounces [N]	Power (W)
Stroke (in.)	0.050	0.125	0.250	0.375	0.500	0.625	0.750	1.000		
Continuous 100%	100 [27.8]	60 [16.7]	30 [8.3]	20 [5.6]	18 [5]	15 [4.2]	10 [2.8]	8 [2.2]	179 [49.8]	8.6
Intermittent 25%	145 [40.3]	110 [30.6]	70 [19.5]	50 [13.9]	40 [11.1]	35 [9.7]	27 [7.5]	20 [5.6]	205 [57]	27
Intermittent 10% <sup>3</sup>	220 [61.2]	184 [51.2]	145 [40.3]	121 [33.6]	102 [28.4]	89 [24.7]	73 [20.3]	58 [16.1]	546 [151.8]	83
Pulse 1% <sup>3</sup>	252 [70.1]	218 [60.6]	180 [50.]	154 [42.8]	137 [38.1]	125 [34.8]	108 [30.]	80 [22.2]	N/A	130

Continuous Duty 100% = 100% On Time

Intermittent Duty 25% = 25% On Time (100 Sec On Max 300 Sec off)

Intermittent Duty 10% = 90% On Time (10 Sec On Max 90 Sec off)

Pulse Duty 1% = 99% On Time (1 Sec On Max 99 Sec off)

<sup>3</sup> - Calculated force values to be verified in application

### Optional Return Spring Kit

A490-367460-00



www.Kelcoind.com

Information contained in this specification sheet subject to change without notice. Guardian Electric ©

