

# DC Tubular Solenoid

## Model T4x12



1425 Lake Avenue, Woodstock, IL 60098

### Features:

High performance construction  
Available return spring kit  
DC solenoid applications only  
See TP4x12 for push application  
RoHS Compliant  
UL Recognized  
Coil Termination: 6.5" Wire leads  
26 AWG (standard)

### Electrical:

Coil Voltages: 6, 12, 24, 48, 110 VDC standard  
Duty Cycle: 100% Continuous, 25% Intermittent,  
10% Intermittent, 1% Pulse  
Coil treatment: Tape Wrapped  
Insulation Class: Class A Rating - 105°C (221°F)  
Dielectric Strength: 1500V 60 Hz

### Mechanical:

Size: 1.5" (L) x 0.5" (D)  
Plunger Diameter: 0.187  
Plunger Guide Material: Plastic  
Mounting: Hex Nut  
Weight: Plunger 0.3 oz, Total 1 oz  
Life Expectancy: 1 Million Cycles<sup>1</sup>

<sup>1</sup> - Dependent on load conditions

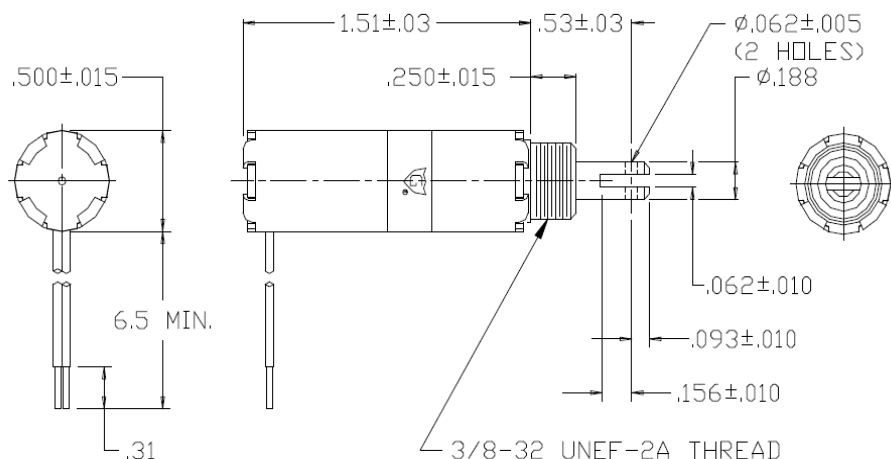

Solenoid shown energized with plunger fully seated  
Supplied with mounting bracket, hex nut and lock washer shipped loose

### Standard Part Numbers

Model	Part Number	Duty Cycle	Voltage	Resistance <sup>2</sup> (Ω)	Power (W)	Current
T4X12-C-12D	A420-066011-00	Cont.	12VDC	49.8	3	241 mA
T4X12-I-12D	A420-066012-00	Inter.	12VDC	24.7	6.1	486 mA
T4X12-C-24D	A420-066013-00	Cont.	24VDC	49.8	3	241 mA
T4X12-I-24D	A420-066014-00	Inter.	24VDC	96.7	6.3	248 mA

<sup>2</sup> - Coil resistance tolerance +/- 5%

Contact us for custom voltages or duty cycles

### Available Customization:

- Plunger
- Lead and Connector
- DC Voltage / Duty Cycle
- Termination
- Insulation systems up to class H 180° C (356° F)

\* Minimum quantities apply

Typical Pull Force Ounces [N] @ 20°C (68°F) (Distance from fully seated position)							HOLDING FORCE Ounces [N]	Power (W)
Stroke (in.)	0.050	0.125	0.250	0.375	0.500	0.625		
Continuous 100%	4 [1.1]	2 [0.6]	1 [0.3]	N/A	N/A	N/A	22 [6.1]	3
Intermittent 25%	7 [1.9]	3 [0.8]	1 [0.3]	N/A	N/A	N/A	25 [7]	6.2
Intermittent 10% <sup>3</sup>	12.5 [3.5]	7.5 [2.1]	5 [1.4]	3.5 [1]	1.5 [0.4]	N/A	43 [12]	22.5
Pulse 1% <sup>3</sup>	18.5 [5.1]	12.5 [3.5]	8.5 [2.4]	6 [1.7]	3.5 [1]	1.5 [0.4]	N/A	70

Continuous Duty 100% = 100% On Time

Intermittent Duty 25% = 25% On Time (100 Sec On Max 300 Sec off)

Intermittent Duty 10% = 90% On Time (10 Sec On Max 90 Sec off)

Pulse Duty 1% = 99% On Time (1 Sec On Max 99 Sec off)

<sup>3</sup> - Calculated force values to be verified in application

Optional Return  
Spring Kit

A490-367460-06



www.Kelcoind.com

Information contained in this specification sheet subject to change without notice. Guardian Electric ©

