

DC Tubular Solenoid

Model T8x16



1425 Lake Avenue, Woodstock, IL 60098

Features:

High performance construction
Available return spring kit
DC solenoid applications only
See TP8x16 for push application
RoHS Compliant
UL recognized
Coil Termination: 6.5" Wire leads
22 AWG (standard)



Electrical:

Coil Voltages: 6, 12, 24, 48, 110 VDC standard
Duty Cycle: 100% Continuous, 25% Intermittent,
10% Intermittent, 1% Pulse
Coil treatment: Tape Wrapped
Insulation Class: Class A Rating - 105°C (221°F)
Dielectric Strength: 1500V 60 Hz

Mechanical:

Size: 2" (L) x 1" (D)
Plunger Diameter: 0.437
Plunger Guide Material: Plastic
Mounting: Hex Nut
Weight: Plunger 1.6 oz, Total 5.8 oz
Life Expectancy: 1 Million Cycles¹

¹ - Dependent on load conditions

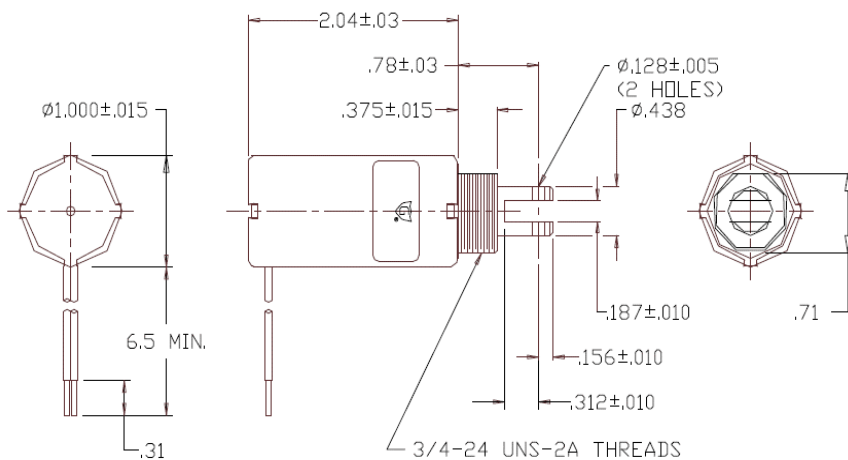

Solenoid shown energized with plunger fully seated
Supplied with mounting bracket, hex nut and lock washer shipped loose

Standard Part Numbers

Model	Part Number	Duty Cycle	Voltage	Resistance ² (Ω)	Power (W)	Current
T8X16-C-12D	A420-066642-00	Cont.	12VDC	28.3	5.3	424 mA
T8X16-I-12D	A420-066643-00	Inter.	12VDC	9.3	16.3	1.29 A
T8X16-C-24D	A420-066644-00	Cont.	24VDC	110	5.5	218 mA
T8X16-I-24D	A420-066645-00	Inter.	24VDC	36.1	16.8	665 mA

² - Coil resistance tolerance +/- 5%

Contact us for custom voltages or duty cycles

Available Customization:

- Plunger
 - Lead and Connector
 - DC Voltage / Duty Cycle
 - Termination
 - Insulation systems up to class H 180° C (356° F)
- * Minimum quantities apply

Typical Pull Force Ounces [N] @ 20°C (68°F) (Distance from fully seated position)									HOLDING FORCE Ounces [N]	Power (W)
Stroke (in.)	0.050	0.125	0.250	0.375	0.500	0.625	0.750	1.000		
Continuous 100%	30 [8.3]	18 [5]	11 [3.1]	5 [1.4]	4 [1.1]	3 [0.8]	2 [0.6]	N/A	103 [28.6]	5.4
Intermittent 25%	60 [16.7]	40 [11.1]	25 [7]	19 [5.3]	15 [4.2]	10 [2.8]	8 [2.2]	N/A	125 [34.8]	16.5
Intermittent 10% ³	93 [25.9]	68.5 [19]	50 [13.9]	41.5 [11.5]	31.5 [8.8]	28.5 [7.9]	25 [7]	17 [4.7]	261 [72.6]	83
Pulse 1% ³	118 [32.8]	95 [26.4]	75 [20.9]	63 [17.5]	55 [15.3]	50 [13.9]	43 [12]	32 [8.9]	N/A	130

Continuous Duty 100% = 100% On Time

Intermittent Duty 25% = 25% On Time (100 Sec On Max 300 Sec off)

Intermittent Duty 10% = 90% On Time (10 Sec On Max 90 Sec off)

Pulse Duty 1% = 99% On Time (1 Sec On Max 99 Sec off)

³ - Calculated force values to be verified in application

Optional Return Spring Kit

A490-367460-02



www.Kelcoind.com

Information contained in this specification sheet subject to change without notice. Guardian Electric ©

